



ELECTRICAL CHARACTERISTICS

	435	324	440	328	445	332	450	335	455	339
	40.3	37.6	40.5	37.8	40.7	38.0	40.9	38.2	41.1	38.4
	10.80	8.62	10.87	8.67	10.94	8.73	11.01	8.78	11.08	8.84
	49.0	45.6	49.2	45.8	49.4	46.0	49.6	46.2	49.8	46.4
	11.33	9.15	11.40	9.20	11.47	9.26	11.54	9.32	11.61	9.37
	20.00		20.20		20.40		20.70		20.90	

C.
C

MECHANICAL CHARACTERISTICS

	Monocrystalline Silicon (9Busbar)
	144pcs in series (6*24)
	2094*1038*35mm (82.44*40.87*1.38inches)
	23.5kg (51.81lbs)
	3.2mm AR Coating Tempered Glass
	Anodized Aluminium Alloy
	IP68, 3 Bypass Diodes
	4mm ² (IEC), 12AWG(UL) 300mm in Length or Customized Length
	T01/LJQ-3-CSY/MC4/MC4-EV02

I-V CURVE

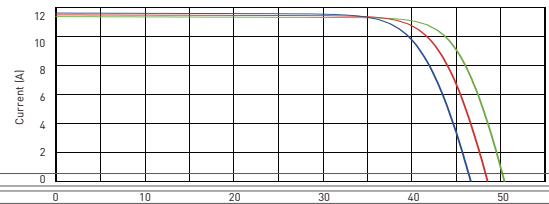
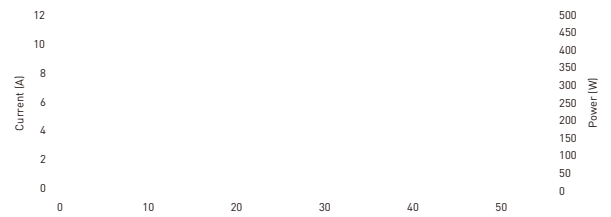

APPLICATION CONDITIONS

	1000W/1500W/DC
	-40°C~+85°C
	20A
	Class II

TEMPERATURE CHARACTERISTICS

	-0.36%/°C
	-0.26%/°C
	+0.043%/°C
	43±2°C

PACKING CONFIGURATION

	31	31(USA)
	715	682

TECHNICAL DRAWINGS

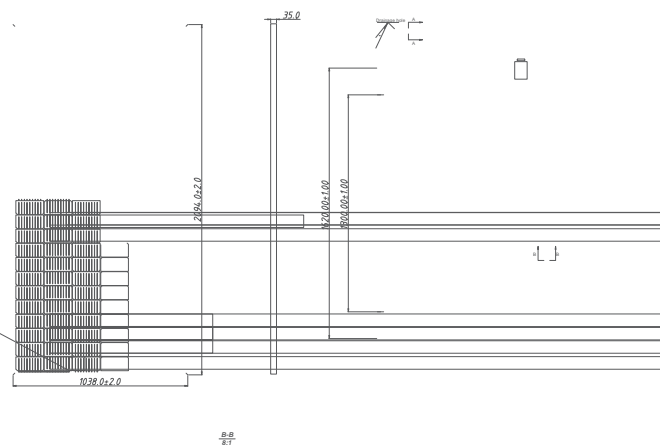

The specific information and features described in this data sheet are made available and are not intended to be used for any purpose other than the intended use. The information is provided for informational purposes only and does not constitute an offer or a contract. The information is subject to change without notice. Please refer to the latest version of the data sheet for the most up-to-date information. The information is provided for informational purposes only and does not constitute an offer or a contract. The information is subject to change without notice. Please refer to the latest version of the data sheet for the most up-to-date information.